



Architecture and Interiors, Ltd.

**College House Administrative Services  
Housing Conference Services  
Stouffer Commons  
University of Pennsylvania**

College House Administrative Services and Housing Conference Services were urban pioneers when they relocated to the former dining hall of Stouffer Commons. The two departments came to appreciate the synergy of working together, so much that when they expanded into the lower level, they invited two other departments to join them.

In support of this communal environment are a common arrival point and multiple access connections. A shared reception station in the renovated lobby greets and directs visitors, who can now reach all floors through a new public stair and elevator carved out of an adjacent bay. Internally, an abandoned elevator shaft has been turned into a private communicating stair.

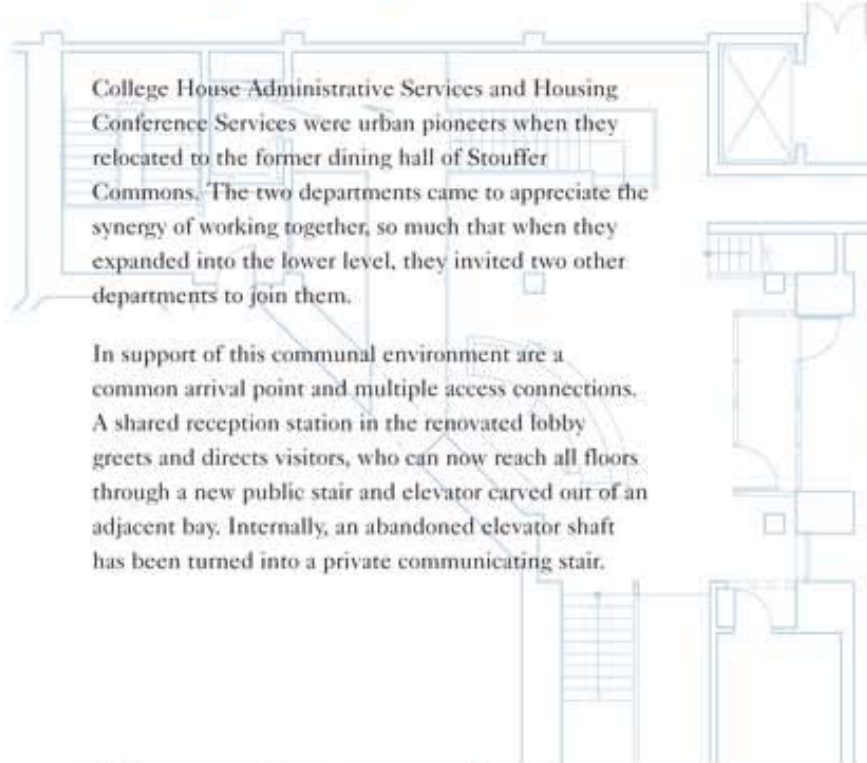

**CDA&I**  
Architecture and Interiors, Ltd.  
225 South 25th Street  
Philadelphia, PA 19103-5555  
www.cdaandi.com

Principal  
Cynthia Stouffer  
VP  
Katie Stouffer  
VP  
Katie Stouffer  
VP  
Katie Stouffer

Principal  
Cynthia Stouffer  
VP  
Katie Stouffer  
VP  
Katie Stouffer

"CDA&I's design ably supports our program, but more than that, by creating multiple physical connections, it has led to improved communications between all the student services departments. From one's first arrival at the lobby to a final destination, there is clearly defined and appropriate access. The result is an open environment that benefits our clients and staff."

—Dong Berger, Director  
Housing and Conference Services, University of Pennsylvania